

# Soils Map

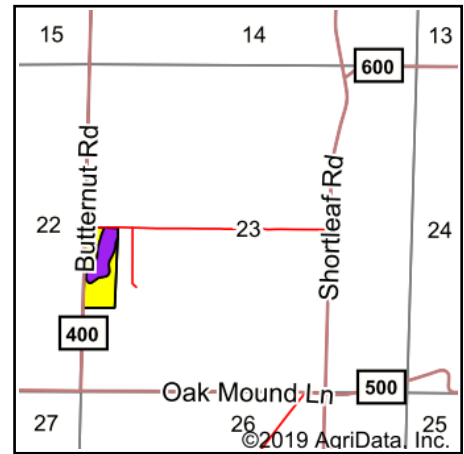

Soils data provided by USDA and NRCS.



State: **Illinois**  
 County: **Clay**  
 Location: **23-3N-5E**  
 Township: **Songer**  
 Acres: **15.78**  
 Date: **1/3/2020**

Maps Provided By:  
  
 CUSTOMIZED ONLINE MAPPING  
 © AgriData, Inc. 2019 www.AgriDataInc.com



Area Symbol: IL025, Soil Area Version: 14

Code	Soil Description	Acres	Percent of field	Il. State Productivity Index Legend	Corn Bu/A	Soybeans Bu/A	Wheat Bu/A	Crop productivity index for optimum management
3A	Hoyleton silt loam, 0 to 2 percent slopes	10.33	65.5%		146	46	58	108
**3B2	Hoyleton silt loam, 2 to 5 percent slopes, eroded	5.45	34.5%		**139	**44	**55	**103
Weighted Average					143.6	45.3	57	106.3

**Table: Optimum Crop Productivity Ratings for Illinois Soil by K.R. Olson and J.M. Lang, Office of Research, ACES, University of Illinois at Champaign-Urbana.** Version: 1/2/2012 Amended Table S2 B811

Crop yields and productivity indices for optimum management (B811) are maintained at the following NRES web site: <http://soilproductivity.nres.illinois.edu/>

\*\* Indexes adjusted for slope and erosion according to Bulletin 811 Table S3

\*c: Using Capabilities Class Dominant Condition Aggregation Method

Soils data provided by USDA and NRCS. Soils data provided by University of Illinois at Champaign-Urbana.