

Soils Map

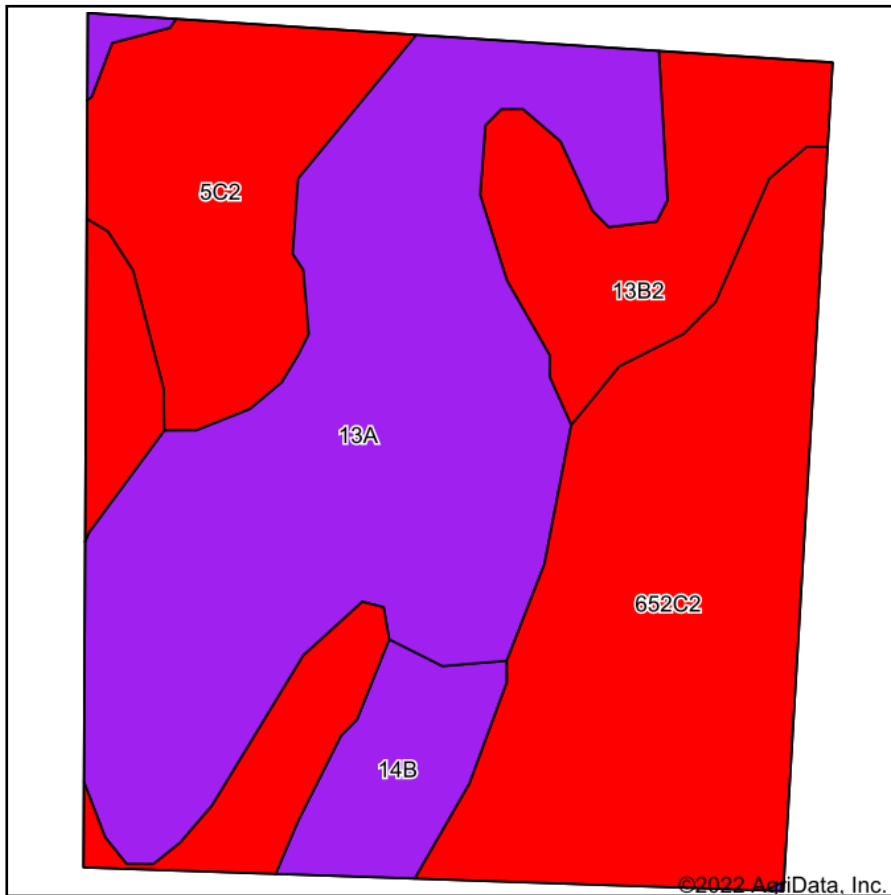

Soils data provided by USDA and NRCS.

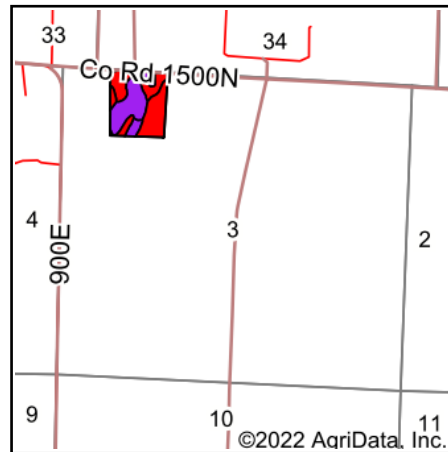

State: **Illinois**
 County: **Wayne**
 Location: **3-1S-6E**
 Township: **Berry**
 Acres: **20.98**
 Date: **9/16/2022**

Maps Provided By:

 CUSTOMIZED ONLINE MAPPING
 © AgriData, Inc. 2021 www.AgriDataInc.com



Area Symbol: IL191, Soil Area Version: 19

Code	Soil Description	Acres	Percent of field	Il. State Productivity Index Legend	Corn Bu/A	Soybeans Bu/A	Wheat Bu/A	Crop productivity index for optimum management
13A	Bluford silt loam, 0 to 2 percent slopes	7.89	37.6%		136	44	55	101
**652C2	Passport silt loam, 5 to 10 percent slopes, eroded	7.15	34.1%		**116	**39	**51	**88
**5C2	Blair silt loam, 5 to 10 percent slopes, eroded	2.72	13.0%		**124	**41	**50	**94
**13B2	Bluford silt loam, 2 to 5 percent slopes, eroded	2.14	10.2%		**129	**42	**52	**96
**14B	Ava silt loam, 2 to 5 percent slopes	1.08	5.1%		**134	**44	**54	**99
Weighted Average					126.8	41.7	52.6	95

Table: Optimum Crop Productivity Ratings for Illinois Soil by K.R. Olson and J.M. Lang, Office of Research, ACES, University of Illinois at Champaign-Urbana. Version: 1/2/2012 Amended Table S2 B811

Crop yields and productivity indices for optimum management (B811) are maintained at the following NRES web site: <http://soilproductivity.nres.illinois.edu/>

** Indexes adjusted for slope and erosion according to Bulletin 811 Table S3

Soils data provided by USDA and NRCS. Soils data provided by University of Illinois at Champaign-Urbana.