

Soils Map

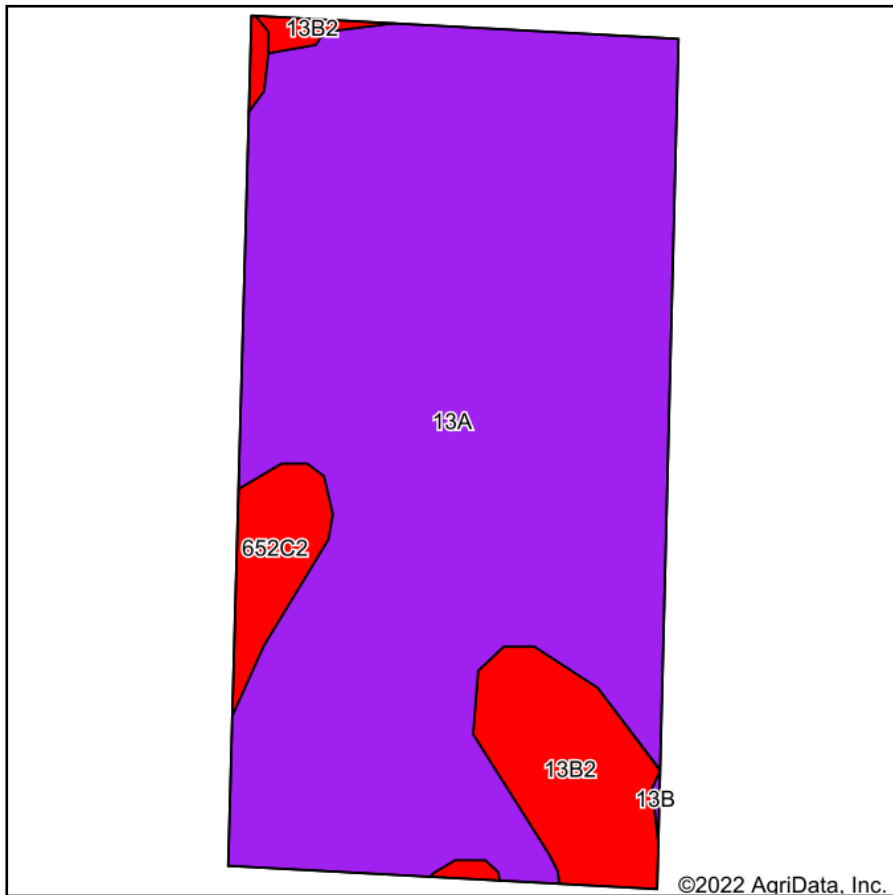

Soils data provided by USDA and NRCS.

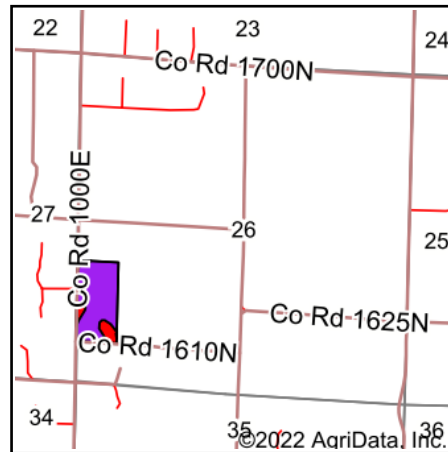

State: **Illinois**
 County: **Wayne**
 Location: **26-1N-6E**
 Township: **Indian Prairie**
 Acres: **20.13**
 Date: **3/4/2022**



Area Symbol: IL191, Soil Area Version: 19

Code	Soil Description	Acres	Percent of field	Il. State Productivity Index Legend	Corn Bu/A	Soybeans Bu/A	Wheat Bu/A	Crop productivity index for optimum management
13A	Bluford silt loam, 0 to 2 percent slopes	17.46	86.7%		136	44	55	101
**13B2	Bluford silt loam, 2 to 5 percent slopes, eroded	1.84	9.1%		**129	**42	**52	**96
**652C2	Passport silt loam, 5 to 10 percent slopes, eroded	0.83	4.1%		**116	**39	**51	**88
Weighted Average					134.5	43.6	54.6	100

Table: Optimum Crop Productivity Ratings for Illinois Soil by K.R. Olson and J.M. Lang, Office of Research, ACES, University of Illinois at Champaign-Urbana. Version: 1/2/2012 Amended Table S2 B811

Crop yields and productivity indices for optimum management (B811) are maintained at the following NRES web site: <http://soilproductivity.nres.illinois.edu/>

** Indexes adjusted for slope and erosion according to Bulletin 811 Table S3

Soils data provided by USDA and NRCS. Soils data provided by University of Illinois at Champaign-Urbana.